

Pre-wired socket outlets Plexo 2P+E to Franco-Belgian standard

Cat. No.(s) : 695 62/63/64/65 - 696 42/43/44

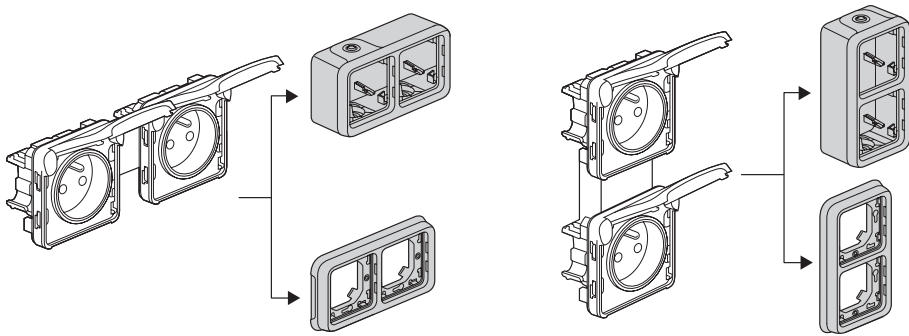

CONTENTS	Page
1. Technical data	1
2. Range	1
3. Preparation	1-2-3
4. Overall dimensions	3
5. General characteristics	3/4
6. Cleaning	4
7. Special uses	4
8. Equipment and accessories	5
9. Conformities and approvals	5

1. TECHNICAL DATA

Weatherproof wiring devices system intended for residential and professional technical premises (garages, cellars, car parks, workshops and industrial kitchens, etc.) as well as outdoor environments (patios, terraces, gardens, camping sites, etc.).
Socket outlets 16 A 250 V~ to the French and Belgian standard, with protective shutters, accept common 2P and 2P+E plugs to the French and Belgian standard.

2. RANGE

Cat. No.	2 versions : grey and white
695 xx 696 xx	Configurable
697 xx 698 xx	Surface-mounting complete Flush-mounting complete
699 xx	DIY

Description	Marketing Cat. Nos	Characteristics	Connection	Weight
CONFIGURABLE 	695 62 696 42	16 A 250 V~	Auto terminals	112 g
	695 65	16 A 250 V~	With screws	112 g
	695 63 696 43	16 A 250 V~	Auto terminals	112 g
Socket outlet 2P+E Franco-Belgian	695 64 696 44	16 A 250 V~	Auto terminals	168 g

	+		GREY		WHITE	=	
			696 72		696 90		
	+		696 83		696 94		
	+		696 61		696 91		
	+		696 85		696 96		
	+		696 80				
	+		696 87		696 98		

3. PREPARATION

3.1 Surface-mounting

- by screwing the base box onto the support using 2 screws Ø 3-4 mm max.
- Plotting template available Cat. No. 695 97 (see page 5).

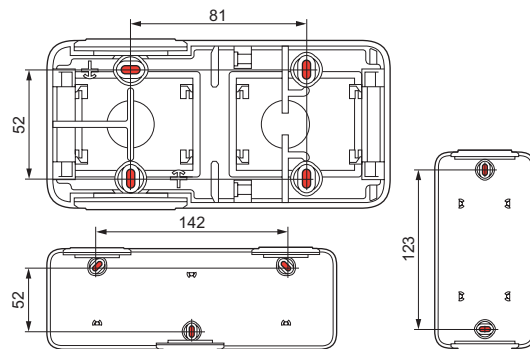

- To replace the former Plexo 55 series

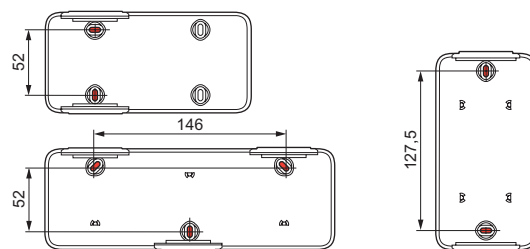

3.2 Flush-mounting

- by screwing onto a flush-mounting box

- for vertical use
- use horizontal flush-mounting boxes (fixing distance 71 mm)
- dry partition
1 x 893 44/54
- masonry
2 x 892 41/51

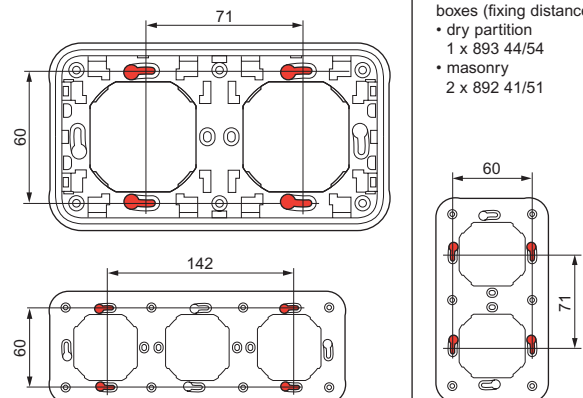

Pre-wired socket outlets Plexo 2P+E to Franco-Belgian standard

Cat. No.(s) : 695 62/63/64/65 - 696 42/43/44

3. PREPARATION (continued)

- By face plate using screws \varnothing 4 mm
- Piercing of support material for diameter 60-70 mm using cylinder saw or punch.

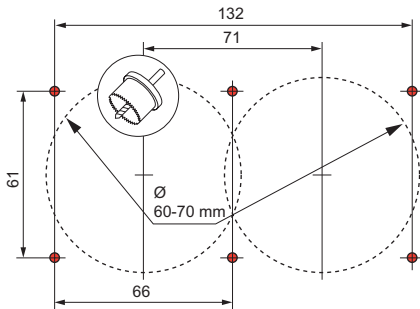
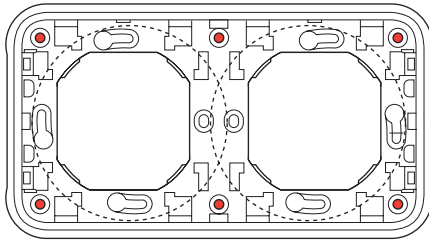

3.3 Connection to conductors

- Automatic terminal mechanisms

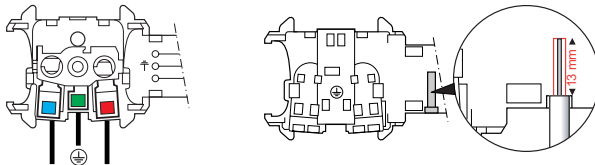

The stripping length required is 13 mm. The correct stripping length can be checked against the gauge on the rear of the base. Terminal capacity is 1.5- 2.5 mm² (1 or 2 conductors).

- Screw terminal mechanisms

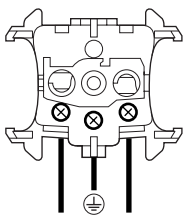

Pillar terminals supplied open, with screws backed off and locked
 Min. capacity : 1 x 1.5 mm²
 Max. capacity : 3 x 2.5 mm² or 2 x 4 mm²
 Max. tightening torque : 0.8 N/m
 Usable screwdrivers : flat blade 3.5-5 mm or Philips No.1

- Connection, tapping

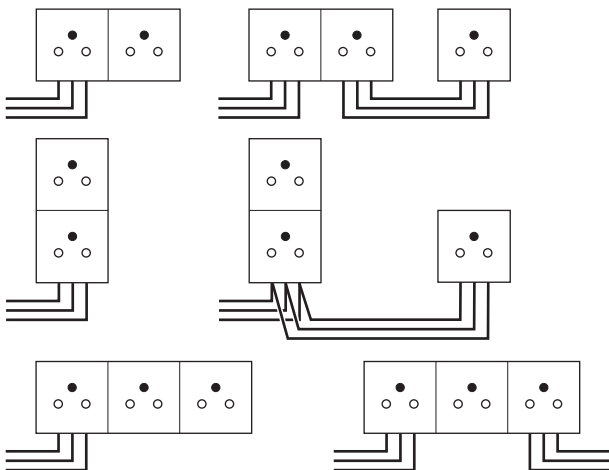

3. PREPARATION (continued)

3.4 Connection to conduits

Type of conduits :

- IRL : formerly IRO, insulating rigid smooth
 - ICA : insulating bendable corrugated
 - ICTA : insulating, bendable, transversally elastic, corrugated
 - ICTL : insulating, bendable, transversally elastic, smooth
- } \varnothing 16-25 mm

Cables (examples) :

- rigid conductors : U - 1000R2V 3G2.5
- flexible conductors : H07 RN - F 3G2.5

Type of outlet glands : membrane flexible, 2 removable types.

- 1-outlet gland supplied on 2 and 3-gang boxes (top)
- 2-outlet gland supplied on 2 and 3-gang boxes (bottom)

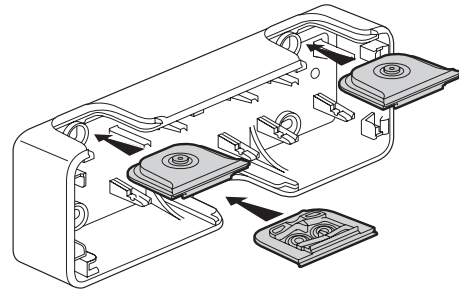

\varnothing 4 - \varnothing 15 mm

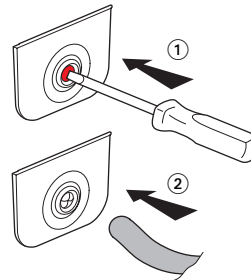

\varnothing 16/20/25 mm

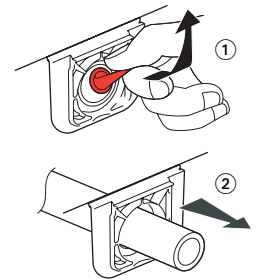

Also available as accessories :

- 695 96 1-outlet gland grey
- 695 99 2-outlet gland grey
- 696 46 1-outlet gland white
- 696 49 2-outlet gland white

3.5 Assembly

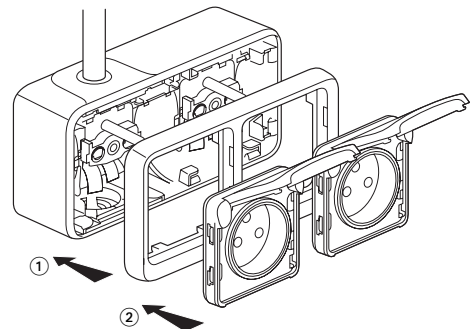

Pre-wired socket outlets Plexo 2P+E to Franco-Belgian standard

Cat. No.(s) : 695 62/63/64/65 - 696 42/43/44

3. PREPARATION (continued)

3.5 Assembly

The front part (cover) is IP55 locked onto the box using four 1/4 turn screws.

The direction of rotation of each 1/4 turn screw is marked on the cover.

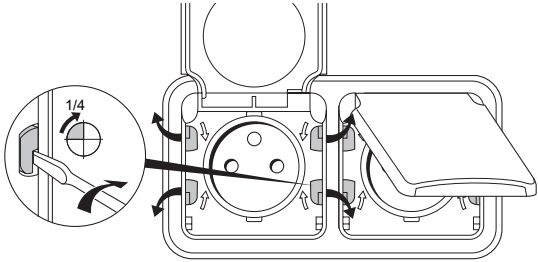

4. OVERALL DIMENSIONS

Configurable

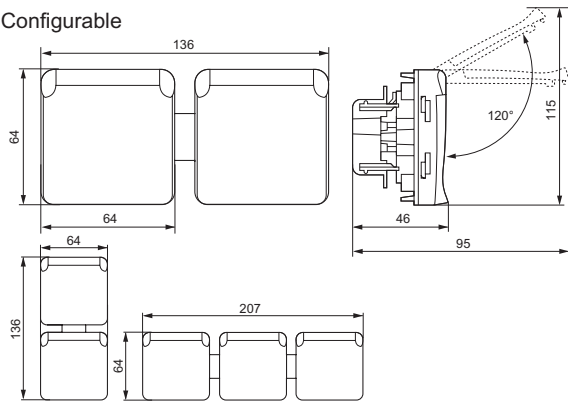

Surface-mounting

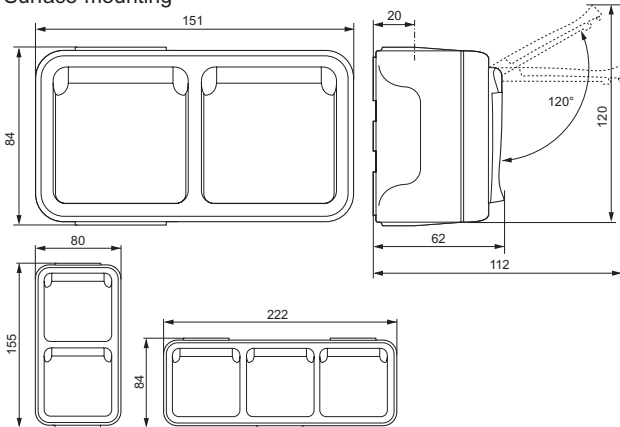

Flush-mounting

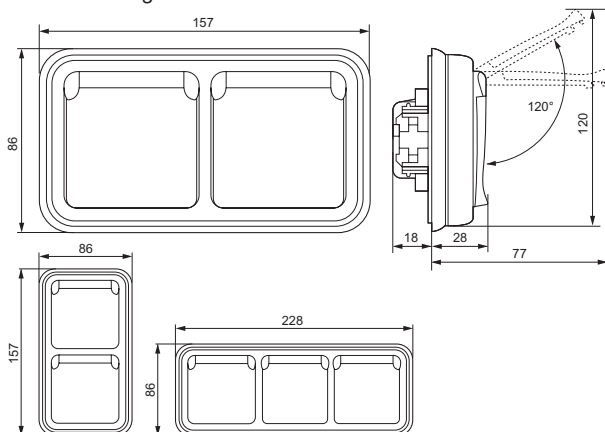

5. GENERAL CHARACTERISTICS

5.1 Mechanical characteristics

Protection index :
- IP 55 IK 07, shutter closed

5.2 Material characteristics

Materials

Box, support : PP reinforced polypropylene
Plate, shutter : ABS (Acrylonitrile Butadiene Styrene)
Entry gland : PP + SEBS (Styrene Ethylene Butadiene Styrene)
Mechanism : PC (Polycarbonate)

5.3 Resistance to chemicals

	Behaviour
Acetone	-
Acetic acid 10 %	+
Acetic acid 30 %	+
Aminosulphanic acid.....	-
Boric acid *	+
Bromhydric acid 47 %	-
Hydrochloric acid *	-
Chromic acid	+
Citric acid *	+
Hydrofluoric acid *	-
Formic acid	-
Lactic acid *	+
Linoleic acid	-
Maleic acid	+
Nitric acid 30 %	-
Nitric acid 50 %	-
Perchloric acid 10 %	+
Phenol-sulphonic acid	-
Phosphoric acid *	+
Sulphuric acid	+
Tannic acid *	-
Tartaric acid *	+
Ethyl alcohol	+
Isopropyl alcohol	+
Methanol	-
Phenylethyl alcohol 100 %	-
Ammonia	+
Electroplating baths :	
- Bright silver bath	+
- Bright cadmium bath	+
- Chrome bath (50° C)	+
- Copper bath (with potassium cyanide)	+
- Copper bath (acid)	+
- Pickling bath with chemical copper	+
- Brass bath	+
- Bright nickel bath	+
Barium	
- Barium chloride *	+
- Barium hydroxide *	+
- Barium nitrate *	-
Benzene	-
Beer	+
Bleaching powder *	+
Cobalt chloride *	-
Copper chloride *	-
Ferrous chloride *	-
Manganese chloride	-
Mercury chloride *	-
Methylene chloride	-
Chlorine water (wet gaseous chlorine)	-
Sea water	+
Fertilizer	+
Epichlorhydrine	-
Heavy gasoline	-
White gasoline	-
Turpentine	-
Essential oils	+
Linseed oil	+
Lubricating oil	+

Pre-wired socket outlets Plexo 2P+E to Franco-Belgian standard

Cat. No.(s) : 695 62/63/64/65 - 696 42/43/44

5. GENERAL CHARACTERISTICS (continued)

5.3 Resistance to chemicals (continued)

Machinery oil	+
Mineral oil	+
Paraffin oil	+
Fish oil	+
Castor oil	+
Silicon oil	+
Humus	+
Aqueous hydrogen sulphide	+
Sodium hypochlorite 10 %	+
Fruit juice	+
Milk	+
Chlorinated detergent	+
Margarine	+
Black oil	+
Mercury	+
Methyl methacrylate	-
Silver nitrate *	+
Cobalt nitrate *	+
Manganese nitrate *	+
Mercury nitrate *	+
Nickel nitrate *	+
Lead nitrate *	+
Petroleum, petroleum ether	-
Silicate (potassium, sodium)	+
Beet syrup	+
Sodium	
- Sodium acetate *	+
- Sodium bromate *	+
- Sodium chloride (salt)*	+
Caustic soda ≤ 40 %	+
Styrene monomer	-
Sugar	+
Trichloroethylene	-
Urine	+
Wine	+

* all concentrations in aqueous solution

Interpretation : + resists - instability

This information is given for guidance, and does not therefore engage our liability.
Consult us for any special use.

5.4 UV resistance

No noticeable change following a 7-day test with irradiance of 550 W/m² (colorimetric measurement according to Lab method).

5.5 Resistance to salt spray : 7 days (168 h)

5.6 Electrical characteristics

- Self-extinguishing to IEC 60695-2-11 :
components (or parts) required to hold live parts in place : 850°C
components (or parts) not required to hold live parts in place : 650°C
- Voltage - Current - Frequency
16 A 250 V~ 50 Hz according to NF C 61-314, NBN C 61-112 and IEC 60884-1.

5.7 Climatic characteristics

Storage and use temperature : - 25°C to + 60°C

6. CLEANING

Surface cleaning with dry cloth or cloth dipped in soapy water. Do not use acetone, tar remover or trichlorethylene.

Important : a test should be carried out before using any specific cleaners.

7. SPECIAL USES

Installations with profile.

The Plexo profile distribution system provides :

- Distribution, protection and branching of different wires and cables in an electrical installation.
- A profile, finishing and routing accessories (profile seal, universal weatherproof junction, flat angle, internal angle, external angle, tee, yoke).
- A new solution for installing weatherproof surface-mounting devices in technical residential and more occasionally commercial situations.
- optimum reliability and safety through compliance with standard NFC 68-104 (IP 42, IK 07).

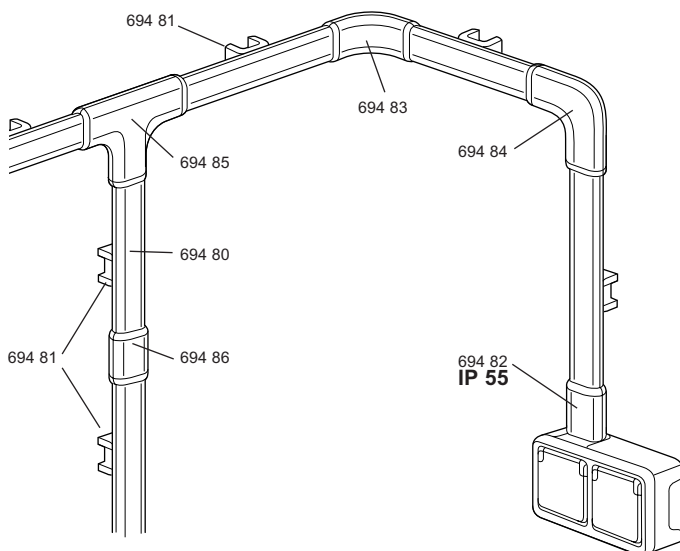





Cat. Nos	Description
694 80	Plexo profile, length 2.00 m, capacity equivalent to IRL Ø 25 mm
694 81	Plexo profile yoke
694 82	Universal weatherproof junction IP55
694 83	Plexo profile internal/external angle
694 84	Plexo profile flat angle
694 85	Plexo profile tee
694 86	Plexo universal joint

- Refer to the Plexo profile specific technical data sheet : F00386FR/00

Pre-wired socket outlets Plexo 2P+E to Franco-Belgian standard

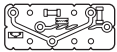
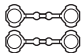
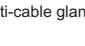

Cat. No.(s) : 695 62/63/64/65 - 696 42/43/44

8. EQUIPMENT AND ACCESSORIES

Description	Uses	Cat. No.	Colour
1-outlet gland 	For making an aesthetic junction between boxes and cables up to Ø 16 mm inclusive	695 96	Grey
		696 46	White
2-outlet gland 		695 99	Grey
		696 49	White
Plotting template 	For rapidly finding the fixing distances of all the boxes	695 97	-
Set of 4 caps 	For blanking the fixing holes at the box base	695 98	Grey
Multi-cable gland 	(PG) Ø 7 - 14 mm	696 53	
Tapping terminal strip 	Direct connection after simple stripping of rigid conductors Terminal capacity : 0.75-2.5 mm ²	343 22	

9. CONFORMITIES AND APPROVALS

- Products produced in compliance with standards :
 - France NF C 61-314
 - Belgium NBN C 61-112
 - International IEC 60884-1
- NF USE approval according to NF C 61-314
- Conform with NF C 15-100 (child protection by shutter system)

Quality marks	Standards	Certificate N°
NF (France) 	NF C 61-314	03/10/2006
CEBEC (Belgium) 	CEI 60884 -1	09/03/2007
BBJ (Poland) 	CEI 60884 -1	In process